

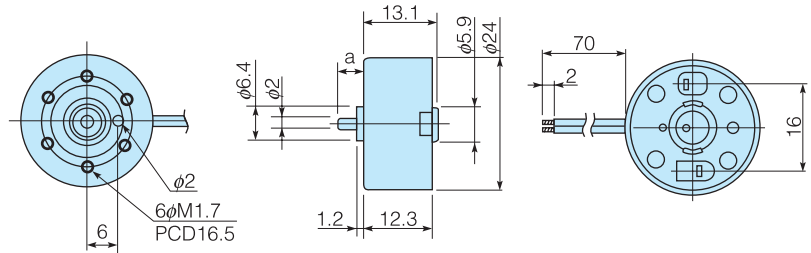

Standard Dimensions(mm)



* Terminal type, Lead wire type and Lead wire with connector type is available

Typical Data

Model	Working Voltage (V)	Rated Voltage (V)	No Load Speed (r/min)	No Load Current (mA)	Rated Load		Rated Load Speed (r/min)	Rated Current (mA)	Starting Torque		Shaft Length (mm)
					(gf·cm)	(mN·m)			(gf·cm)	(mN·m)	
MDN3BT3CRAS	0.7 to 6.0	2	3280	22	4	0.392	2470	93	16.0	1.569	a= 6.0
MDN3BL3CSAS	0.7 to 6.0	2	2290	17	4	0.392	1480	71	12.0	1.177	a= 6.0
MDN3SL3DVB	0.7 to 6.0	3	3010	30	4	0.392	2590	55	28.5	2.793	a= 7.2

Characteristics

